

IMPORTANT SAFETY INSTRUCTIONS

When using electrical appliances, especially when children are present, basic safety precautions should always be followed, including the following:

READ ALL INSTRUCTIONS BEFORE USING

KEEP AWAY FROM WATER

DANGER

— Any hair dryer is electrically live even when the switch is off. To reduce the risk of death or injury by electric shock:

1. Always "unplug it" immediately after using.
2. Do not use while bathing or in a shower.
3. Do not place or store appliance where it can fall or be pulled into a tub or sink.
4. Do not place in, or drop into, water or other liquid.
5. If an appliance falls into water, "unplug it" immediately. **Do not reach into the water.**

WARNING

— To reduce the risk of burns, electrocution, fire, or injury to persons:

1. **This appliance should never be left unattended when plugged in.**
2. Close supervision is necessary when this appliance is used by, on, or near children or individuals with certain disabilities.

3. Use this appliance only for its intended use as described in this manual. Do not use attachments not recommended by the manufacturer.

4. Never operate this appliance if it has a damaged cord or plug, if it is not working properly, if it has been dropped, damaged, or dropped into water. Return the appliance to a Conair service center for examination and repair.

5. Keep the cord away from heated surfaces. **Do not pull, twist, or wrap line cord around dryer, even during storage.**

6. Never block the air openings of the appliance or place it on a soft surface, such as a bed or couch, where the air openings may be blocked. Keep the air openings free of lint, hair, and the like.

7. Never use while sleeping.

8. Never drop or insert any object into any opening or hose.

9. Do not use outdoors or operate where aerosol (spray) products are being used or where oxygen is being administered.

10. Do not use an extension cord to operate dryer.

11. Do not direct hot air toward eyes or other heat-sensitive areas.

12. Attachments may be hot during use. Allow them to cool before handling.

13. Do not place appliance on any surface while it is operating.

14. While using the appliance, keep your hair out of it. Keep your hair away from the air inlets.

15. Do not use with voltage converter.

For a dual voltage hair dryer:

16. Be sure dual voltage selector is in correct voltage position before operating. Before plugging in, read the information about dual voltage contained in this instruction section of this manual.

17. This appliance was set at the factory to operate at 125 volts. Refer to Additional Information section of this manual for conversion to 250 volts operation.

SAVE THESE INSTRUCTIONS OPERATING INSTRUCTIONS

This appliance is intended for household use only. Use on Alternating Current (60 hertz) only. Standard Dryers are designed to operate at 110 to 125 volts A.C.

This appliance has a polarized plug (one blade is wider than the other). As a safety feature, this plug will fit in a polarized outlet only one way. If the plug does not fit fully in the outlet, reverse the plug. If it still does not fit, contact a qualified electrician. Do not attempt to defeat this safety feature.

CHECK ALCI SAFETY FEATURE EVERY TIME YOU USE APPLIANCE.

This appliance is equipped with an Appliance Leakage Circuit Interrupter (ALCI), a safety feature that renders it inoperable under some abnormal conditions, such as immersion in water. To make sure the ALCI is functioning properly, perform the following test. The purpose of this test is to allow you to make sure the water sensing system (ALCI) is working.

1. Plug in the appliance and press test button on plug (See appropriate diagram below).
2. The appliance will stop working. There will be an audible click and reset button will pop out.
3. To reset ALCI with a reset button, units should be unplugged. Then push reset button in, and reinsert plug into outlet.

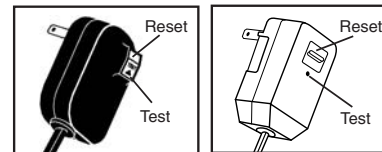

4. If ALCI is not functioning properly, return appliance to nearest service center.

5. It is important that if immersion occurs, this unit be brought to a service center. Do not try to reset.

6. Be sure to repeat test every time you use the unit to confirm ALCI is operational.

Should the appliance go off and the reset button pop up during use, this could indicate a malfunction in the unit. Remove plug from outlet and allow the hot airbrush to cool. Reinsert plug into outlet.

The appliance should function normally. If not, return to an authorized Conair Service Center for examination and repair.

SUPER STYLING GUIDE

Your best looks begin with a good haircut that's well maintained. Always treat hair right with superior quality shampoos, conditioners, and finishing products.

DRYING BASICS

1. Shampoo and condition hair with products of your choice. Rinse thoroughly. Towel blot hair to remove excess moisture. Section hair. Using the dryer along with your styling brush, direct hot air through a section of hair at a time. Move dryer steadily across each section so that the hot air passes through hair. Direct air flow at hair not scalp.

2. Keep dryer's air intake vents unobstructed and free from hair while drying.

3. To avoid over drying, do not concentrate heat on any one section for any length of time. Keep dryer moving as you style.

4. For quick touch ups, between shampoos, dampen hair with a mist of water before styling with the dryer.

5. When using your dryer to create curls and waves, dry hair almost completely on a warmer temperature setting, then finish styling with Cool Shot feature to close hair shaft and lock in style.

BODY & VOLUME

To create extra volume, turn head upside down while drying. Position the air flow toward the roots for maximum lift. When hair is dry, toss head back and brush hair into place.



STRAIGHTENING

Work with hair in sections when creating a super straight look. Using a large round brush (approximately 2" diameter), hold hair taut in each section and bend ends slightly under as you dry.



MAKING WAVES

Tousled, natural-looking waves are easily created by grasping hair at the roots and scrunching between fingertips while drying.



GETTING TO KNOW YOUR HAIRDRYER

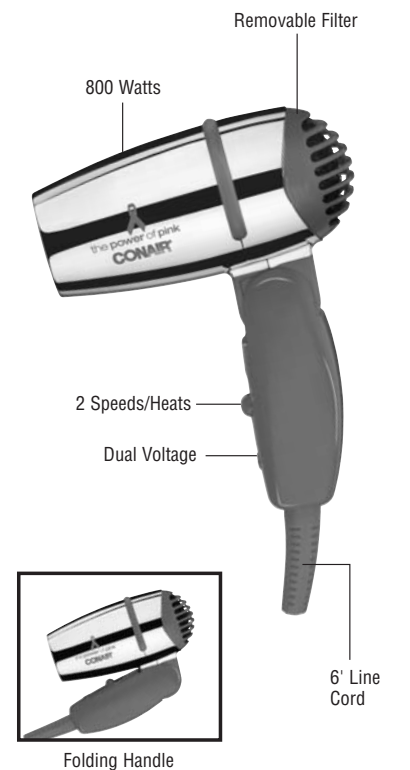



This message about...

GROUND
FAULT
CIRCUIT
INTERRUPTERS

...can save a life!

IF YOU MUST USE YOUR HAIR DRYER IN THE BATHROOM, INSTALL A GFCI* NOW!

Your local electrician can help you decide which type is best for you—a portable unit that plugs into the electrical outlet or a permanent unit installed by your electrician. The National Electrical Code now requires GFCI's in the bathrooms, garages, and outdoor outlets of all new homes.

WHY DO YOU NEED A GFCI? Electricity and water don't mix. If your hair dryer falls in water while it's plugged in, the electric shock can kill you...**even if the switch is "off."** A regular fuse or circuit breaker won't protect you under these circumstances. A GFCI offers you far greater protection.



A GFCI can save your life! Compared to that, the price is small! Don't wait...install one now!

*GFCI is a sensitive device which reacts immediately to a small electric current leak by stopping the electricity flow.

ADDITIONAL INFORMATION

FOR DUAL-VOLTAGE DRYERS

For use in the U.S.A., the voltage selector switch should be placed in the 125 position. For use in several countries overseas, the voltage selector may need to be placed in the 250 position. Confirm the voltage available at each overseas location before using the appliance. For connection to a 240-volt supply, use an attachment plug adapter of the proper configuration for the power supply.

For 110-125 Volt Operation

Turn the dual voltage switch to the 125 position. In this position, the dryer has two settings. It provides two speeds and two heats—low speed and low heat on LO and high speed and high heat on HI.

For 220-250 Volt Operation

First put the HI-LO switch into LO. Turn the Dual voltage switch to the 250 position. At 220-250V while set at LO, the dryer operates only at high speed with high heat. **Do not attempt to operate the HI-LO switch or change to 125 position when operating on 220-250V. The switches must be set and remain in the LO and 250 positions.** A plug adapter may be necessary in certain countries.

USER MAINTENANCE

Your dryer is virtually maintenance free. No lubrication is needed. For proper operating performance, the dryer must be kept clean. When cleaning is needed, unplug the cord, and clean dust and lint from air intake openings with a small brush or the brush attachment of a vacuum cleaner. The outer surface of the dryer should be wiped clean with a damp cloth only.

Blocked or clogged air intake vents will cause the dryer to overheat. If overheating occurs, an automatic safety device will shut the dryer or the heat off to prevent damage or personal injury. If the unit or the heat cycles off, unplug the cord and allow the dryer to cool for 10 to 15 minutes before restarting. Make sure the air vents are clean.

CAUTION

NEVER allow the power supply cord to be pulled, twisted, or severely bent. Never wrap the cord tightly around the dryer. Damage will occur at the high flex point of entry into the dryer, causing it to rupture and short. Inspect the cord frequently for damage. **Stop use immediately if damage is visible or unit stops or operates intermittently.** If the cord or dryer is damaged or does not operate properly, return it for repair to an authorized Conair service representative only. No repairs should be attempted by the consumer.

STORAGE - Important

When not in use, your dryer should be disconnected and stored in a safe, dry location, out of reach of children. **Do not wrap line cord around dryer.** Allow the cord to hang or lie loose and straight at the point of entry into the dryer.



LIMITED ONE YEAR WARRANTY

Conair will repair or replace, at our option, your appliance free of charge for 12 months from the date of purchase if the appliance is defective in workmanship or materials.

To obtain service under this warranty, return the defective product to the service center nearest you, together with your sales slip and \$3.00 for postage and handling. California residents need only provide proof of purchase and should call 1-800-3-CONAIR for shipping instructions. In the absence of a receipt, the warranty period shall be 12 months from the date of manufacture.

ANY IMPLIED WARRANTIES, OBLIGATIONS, OR LIABILITIES, INCLUDING BUT NOT LIMITED TO THE IMPLIED WARRANTY OF MERCHANTABILITY AND FITNESS FOR A PARTICULAR PURPOSE, SHALL BE LIMITED IN DURATION TO THE 12 MONTH DURATION OF THIS WARRANTY. Some states do not allow limitations on how long an implied warranty lasts, so the above limitations may not apply to you.

IN NO EVENT SHALL CONAIR BE LIABLE FOR ANY SPECIAL, INCIDENTAL, OR CONSEQUENTIAL DAMAGES FOR BREACH OF THIS OR ANY OTHER WARRANTY, EXPRESS OR IMPLIED, WHATSOEVER. Some states do not allow the exclusion or limitation of special, incidental, or consequential damages, so the above limitation may not apply to you. This warranty gives you specific legal rights, and you may also have other rights which vary from state to state.

SERVICE CENTER:
CONAIR CORPORATION
Service Department
7475 N. Glen Harbor Blvd
Glendale, AZ 85307
©2004 CONAIR CORPORATION
04PC2391

IB-5551



CONAIR®

Instruction & Styling Guide

Model 054PK